

# 1、SCOPE

This specification applies to CA70 series bi-polar axial solid tantalum electrolytic capacitor produced by Shenzhen Be-Top Electronic Components Co., Ltd.

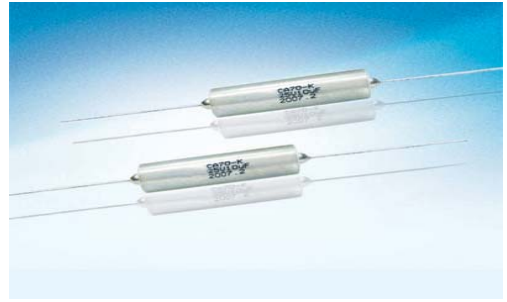

# 2、Brief Introduction

CA70 series bi-polar axial solid electrolyte tantalum capacitors are fully sealed and metal coating sealed with polar axial leads. The series capacitors are characterized by low DC Leakage and dissipation factor, stable performances, high reliability and long usage life. CA70 series meets the standard SJ/T10504-94 and it is widely used in DC or pulse circuits of communication equipments and some other testing equipments.

# 3、General Specification

- 1) Operating Temperature: -55 °C ~+125 °C (using derating voltage when the temperature is higher than 85°C). (see table 1)
- 2) Capacitance Tolerance: ±10% (K) , ±20% (M)
- 3) Current Leakage at Room Temperature:  
 $I_0 \leq 0.02C_R U_R (\mu A)$  or 1μA (whichever is greater)
- 4) Dissipation Factor at -55°C, 25°C, 85°C 125°C. (see table 2).
- 5) Product Dimension and max weight (see table 3).

**Table 1: Relation between Rated Voltage, Derating Voltage and Capacitance**

Rated Voltage $U_R(V)$	6.3	10	16	25	32	40	63
Derating Voltage $U_C(V)$	4	6.3	10	16	20	25	40
Case Code	Capacitance $C_R(\mu F)$						
1	0.47	0.33	0.15	0.15	0.10	0.10	0.10
	0.68	0.47	0.22	0.22	0.15	0.15	0.15
	1.0	0.68	0.33	0.33	0.22	0.22	0.22
	1.5	1.0	0.47	0.47	0.33	0.33	
	2.2	1.5	0.68	0.68	0.47	0.47	
	3.3	2.2	1.0	1.0	0.68		
	4.7	3.3	1.5	1.5			
2	6.8	4.7	2.2	2.2	1.0	0.68	0.33
	10	6.8	3.3	3.3	1.5	1.0	0.47
	15	10	4.7	4.7	2.2	1.5	0.68
	22	15	6.8	6.8	3.3	2.2	1.0
	33	22	10	10	4.7	3.3	1.5
3	47	33 47	22 33	10 15	6.8	4.7 6.8	2.2
	68 100	68	47	22 33	10 15	10 15	3.3 4.7
5	150 220	100 150	68 100	47	22 33	22	6.8 10
	330	220	150	68	47	33	15
6	470	330	220	100	68	47	22

**Table 2: Electrical Characteristics**

Capacitance $C_R$ ( $\mu F$ )	Change of Capacitance (%)			Max					
				Dissipation Factor $\text{tg } \delta$ (%)				Leakage Current ( $\mu A$ )	
	-55°C	85°C	125°C	-55°C	25°C	85°C	125°C	85°C	125°C
$\leq 0.47$	$\pm 8$	$\pm 8$	$\pm 10$	3	3	3	3	$8I_0$	$10I_0$
0.68~33				5	5	5	5		
47~150				6	6	6	6		
220~470				8	8	8	8		

**Table 3: Product Dimension and Max Weight**

Case Code	Max Weight (g)	Without Insulation Sleeve		With Insulation Sleeve		$d \pm 0.1$ (mm)
		$D \pm 0.5$ (mm)	$L \pm 2$ (mm)	$D_1 \text{max}$ (mm)	$L \text{max}$ (mm)	
1	1.5	4	16	4.0	18	0.4
2	4.5	6	25	6.8	27	0.6
3	6	7	30	7.8	32	0.6
4	8	9	30	9.8	32	0.8
5	15	9	45	9.8	47	0.8
6	32	11	45	11.8	47	0.8

**Figure of Product**

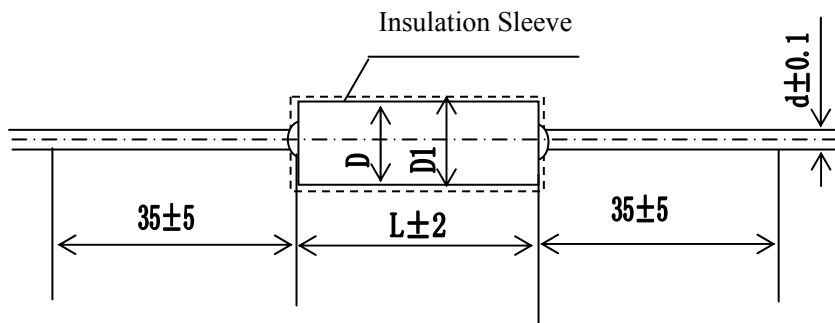

**How to order**

**CA70-106M025**

CA70	106	M	025
Type	Capacitance	Tolerance	Rated Voltage
CA70 Series bi-polar axial solid tantalum capacitor	106=10 $\mu F$	K= $\pm 10\%$ M= $\pm 20\%$	6.3V=006
			10V=010
			16V=016
			25V=025
			32V=032
			40V=040
			63V=063